

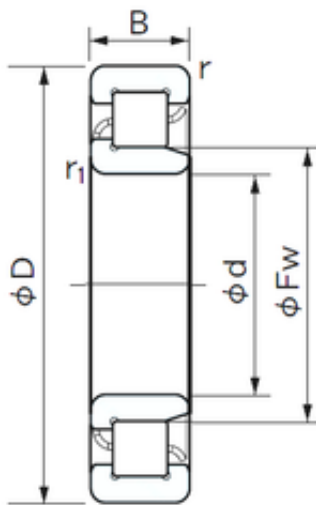

High Temperature BEARINGS CO., LTD



105 mm x 160 mm x 26 mm NACHI NJ 1021
cylindrical roller bearings

Bearing No. NJ 1021

Dimensione	105x160x26 mm
Marchio	NACHI
Diametro del foro	105 mm
Diametro esterno	160 mm
Larghezza	26 mm
d	105 mm
Fw	119.5 mm
D	160 mm
B	26 mm
r min.	2 mm
r1 min.	1.1 mm
Peso	1.88 Kg
Carico dinamico di base (C)	101 kN
Carico statico di base (C0)	136 kN
(Grease) Velocità di lubrificazione	4000 r/min

NJ 1021 Bearing 2D drawings and 3D CAD models